

BOUNDARY SURVEY WITH IMPROVEMENTS
 OF A PORTION OF FRACTIONAL SECTION 24
 TOWNSHIP 2 NORTH RANGE 8 WEST,
 ESCAMBIA COUNTY, FLORIDA

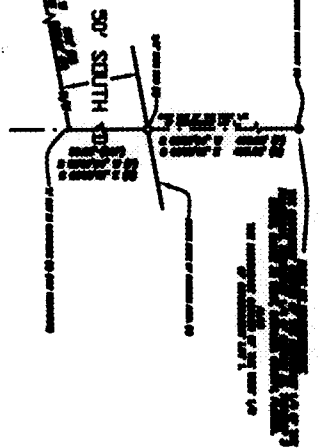
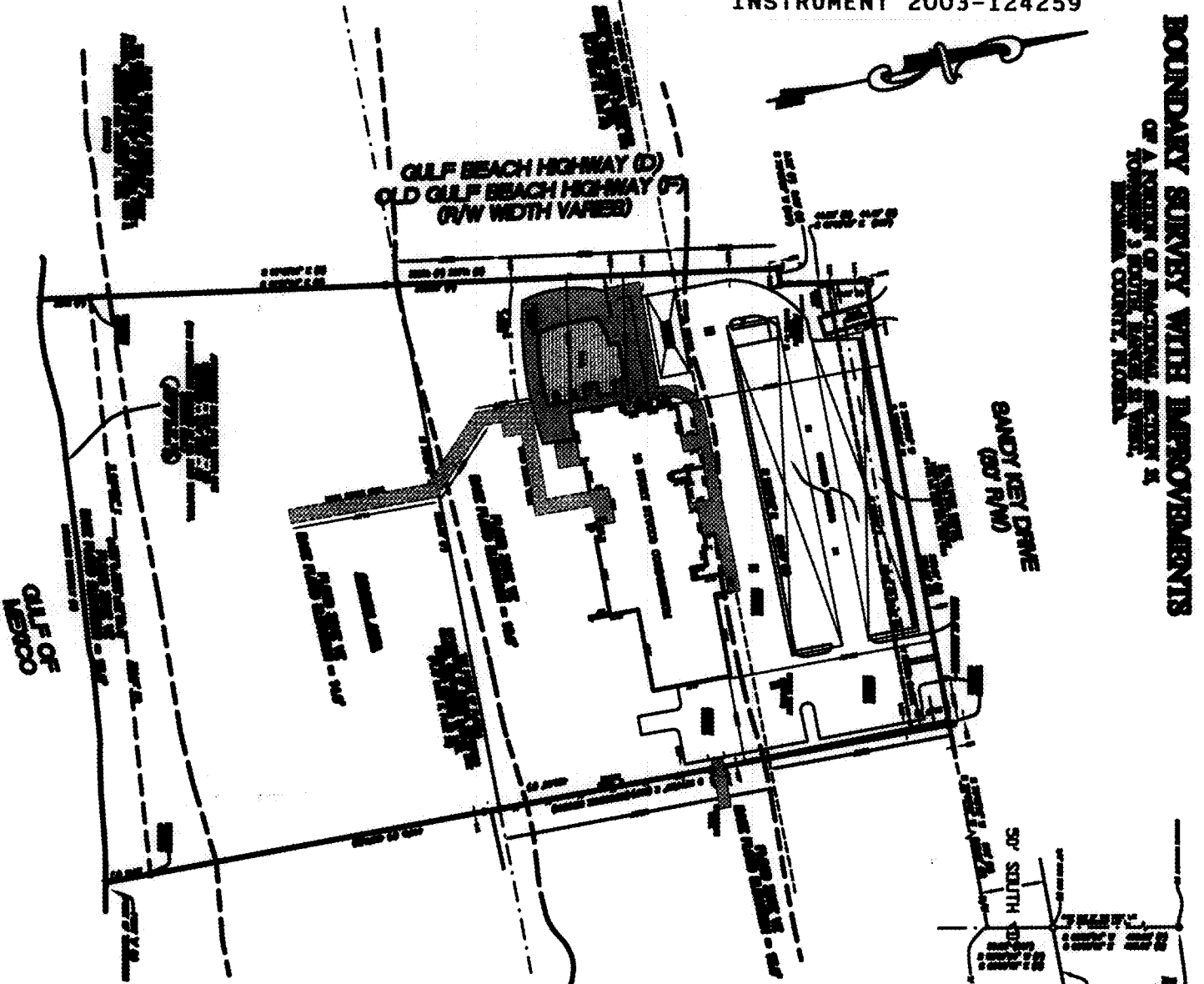

DESCRIPTION
 This is a boundary survey with improvements of a portion of fractional section 24, township 2 north, range 8 west, escambia county, florida, as shown on the plat of the same, recorded in public records of escambia county, florida, book 5193, page 1607.

GENERAL NOTES
 1. THE BOUNDARY SURVEY WAS MADE BY THE SURVEYOR IN ACCORDANCE WITH THE PROVISIONS OF CHAPTER 322, F.S., AND THE RULES OF PRACTICE OF THE BOARD OF PROFESSIONAL ENGINEERS AND SURVEYORS OF THE STATE OF FLORIDA.
 2. THE SURVEY WAS MADE BY THE SURVEYOR IN ACCORDANCE WITH THE PROVISIONS OF CHAPTER 322, F.S., AND THE RULES OF PRACTICE OF THE BOARD OF PROFESSIONAL ENGINEERS AND SURVEYORS OF THE STATE OF FLORIDA.
 3. THE SURVEY WAS MADE BY THE SURVEYOR IN ACCORDANCE WITH THE PROVISIONS OF CHAPTER 322, F.S., AND THE RULES OF PRACTICE OF THE BOARD OF PROFESSIONAL ENGINEERS AND SURVEYORS OF THE STATE OF FLORIDA.
 4. THE SURVEY WAS MADE BY THE SURVEYOR IN ACCORDANCE WITH THE PROVISIONS OF CHAPTER 322, F.S., AND THE RULES OF PRACTICE OF THE BOARD OF PROFESSIONAL ENGINEERS AND SURVEYORS OF THE STATE OF FLORIDA.
 5. THE SURVEY WAS MADE BY THE SURVEYOR IN ACCORDANCE WITH THE PROVISIONS OF CHAPTER 322, F.S., AND THE RULES OF PRACTICE OF THE BOARD OF PROFESSIONAL ENGINEERS AND SURVEYORS OF THE STATE OF FLORIDA.
 6. THE SURVEY WAS MADE BY THE SURVEYOR IN ACCORDANCE WITH THE PROVISIONS OF CHAPTER 322, F.S., AND THE RULES OF PRACTICE OF THE BOARD OF PROFESSIONAL ENGINEERS AND SURVEYORS OF THE STATE OF FLORIDA.
 7. THE SURVEY WAS MADE BY THE SURVEYOR IN ACCORDANCE WITH THE PROVISIONS OF CHAPTER 322, F.S., AND THE RULES OF PRACTICE OF THE BOARD OF PROFESSIONAL ENGINEERS AND SURVEYORS OF THE STATE OF FLORIDA.
 8. THE SURVEY WAS MADE BY THE SURVEYOR IN ACCORDANCE WITH THE PROVISIONS OF CHAPTER 322, F.S., AND THE RULES OF PRACTICE OF THE BOARD OF PROFESSIONAL ENGINEERS AND SURVEYORS OF THE STATE OF FLORIDA.
 9. THE SURVEY WAS MADE BY THE SURVEYOR IN ACCORDANCE WITH THE PROVISIONS OF CHAPTER 322, F.S., AND THE RULES OF PRACTICE OF THE BOARD OF PROFESSIONAL ENGINEERS AND SURVEYORS OF THE STATE OF FLORIDA.
 10. THE SURVEY WAS MADE BY THE SURVEYOR IN ACCORDANCE WITH THE PROVISIONS OF CHAPTER 322, F.S., AND THE RULES OF PRACTICE OF THE BOARD OF PROFESSIONAL ENGINEERS AND SURVEYORS OF THE STATE OF FLORIDA.

STATE OF FLORIDA
 ESCAMBIA COUNTY
 PUBLIC RECORDS
 NOV 30 2003
 KORI
 REGISTERED PROFESSIONAL SURVEYOR
 STATE OF FLORIDA
 No. 124259

BOUNDARY SURVEY WITH IMPROVEMENTS OF A PORTION OF FRACTIONAL SECTION 24, TOWNSHIP 2 NORTH, RANGE 8 WEST, ESCAMBIA COUNTY, FLORIDA. REQUESTED BY & PREPARED FOR LAPATA CONSULTING	NORTHWEST FLORIDA LAND SURVEYING, INC. REGISTERED PROFESSIONAL SURVEYORS 1000 W. 10th Ave., Suite 100 Panama City, FL 32401 (904) 371-1111 www.nwfls.com	SEE OLD SURVEY FOR THE SIGNATURE AND ORIGINAL SEAL OF A FLORIDA LICENSED PROFESSIONAL LAND SURVEYOR	NO.	REV.	DATE	REVISIONS