

THE UNDERSIGNED, HENRY NORRIS, A REGISTERED ARCHITECT IN THE STATE OF ALABAMA, REGISTRATION NUMBER 2865, PURSUANT TO SECTION 35-9A-203, CODE OF ALABAMA, 1978, HEREBY CERTIFIES THAT TO THE BEST OF HIS KNOWLEDGE, DRAWINGS CONSISTING OF THESE ARCHITECTURAL DRAWINGS, INCLUDING THIS FLOOR PLAN, FOR THE CONDOMINIUM OF SANIBEL, A CONDOMINIUM, CONTAINS ALL INFORMATION REQUIRED BY SAID SECTION, FULLY AND ACCURATELY DEPICT THE LAYOUT, LOCATIONS, UNIT NUMBERS AND DIMENSIONS OF THE COMMON ELEMENTS AND PRIVATE ELEMENTS COMPRISING SUCH UNITS OF SAID CONDOMINIUM AS BUILT.  
ALABAMA REGISTRATION NUMBER 2865 DATE 12/20/06

APT Box 25 page 54

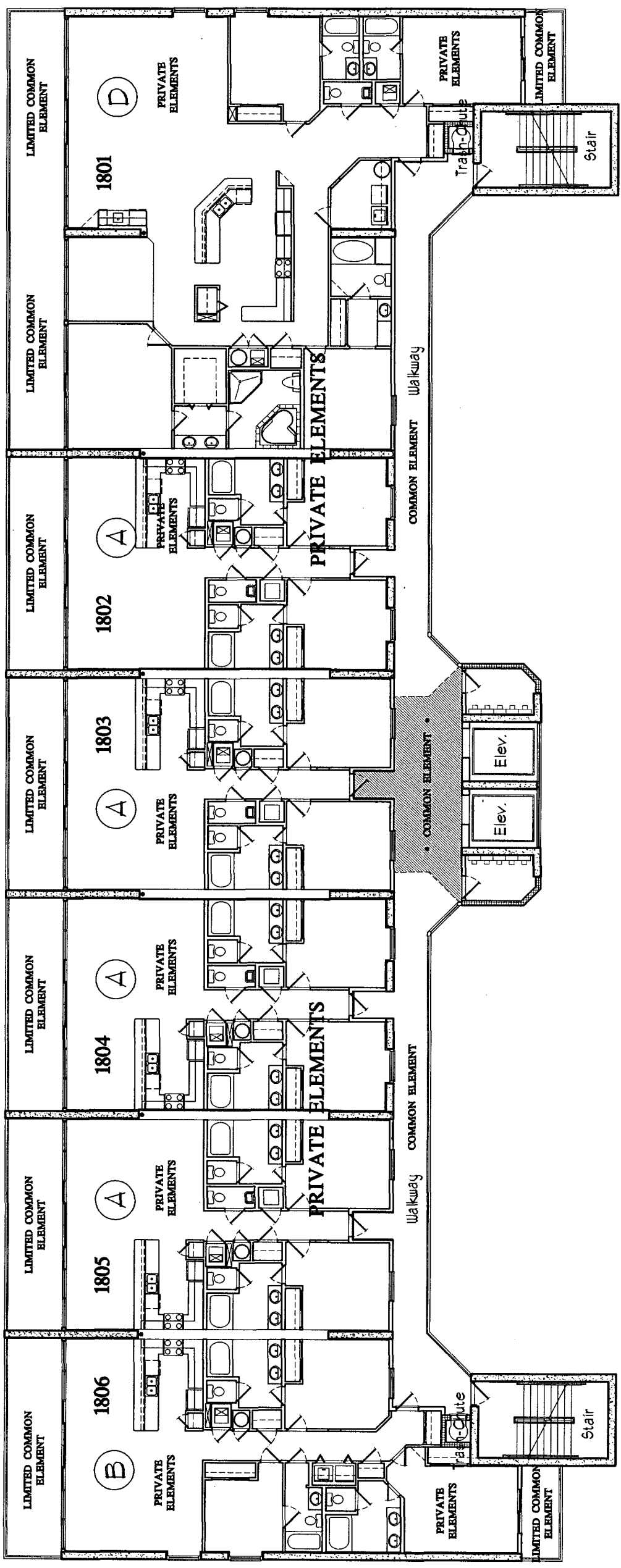

**Typical Building Level 17**  
N.T.S.

NOTE:  
ALL RESIDENTIAL UNIT BALCONIES ARE TO BE LIMITED COMMON ELEMENT  
ALL RESIDENTIAL UNITS ARE TO BE PRIVATE ELEMENT  
ALL WALKWAYS ARE TO BE COMMON ELEMENT  
ALL OTHER AREAS TO BE COMMON ELEMENT UNLESS OTHERWISE NOTED

