

THE UNDERSIGNED, HENRY NORRIS, A REGISTERED ARCHITECT IN THE STATE OF ALABAMA, REGISTRATION NUMBER 2005, PURSUANT TO SECTION 55A-2-20, CODE OF ALABAMA 1975, HEREBY CERTIFIES THAT TO THE BEST OF HIS KNOWLEDGE, DRAWINGS CONSISTING OF THIS SET OF ARCHITECTURAL DRAWINGS FOR THE CONDOMINIUM PROJECT OF SAID CONDOMINIUM OF GANIBEL, A CONDOMINIUM, CONTAINS ALL INFORMATION REQUIRED BY SAID SECTION, FULLY AND ACCURATELY DEPICT THE LAYOUT, LOCATIONS, UNIT NUMBERS AND LIMITS OF COMMON ELEMENTS AND PRIVATE ELEMENTS AND THE APPLICABLE ELEMENTS TO SAID CONDOMINIUM AS BUILT.

ASB/ALC 12/20/06
DATE

Apt Book 25 page 53

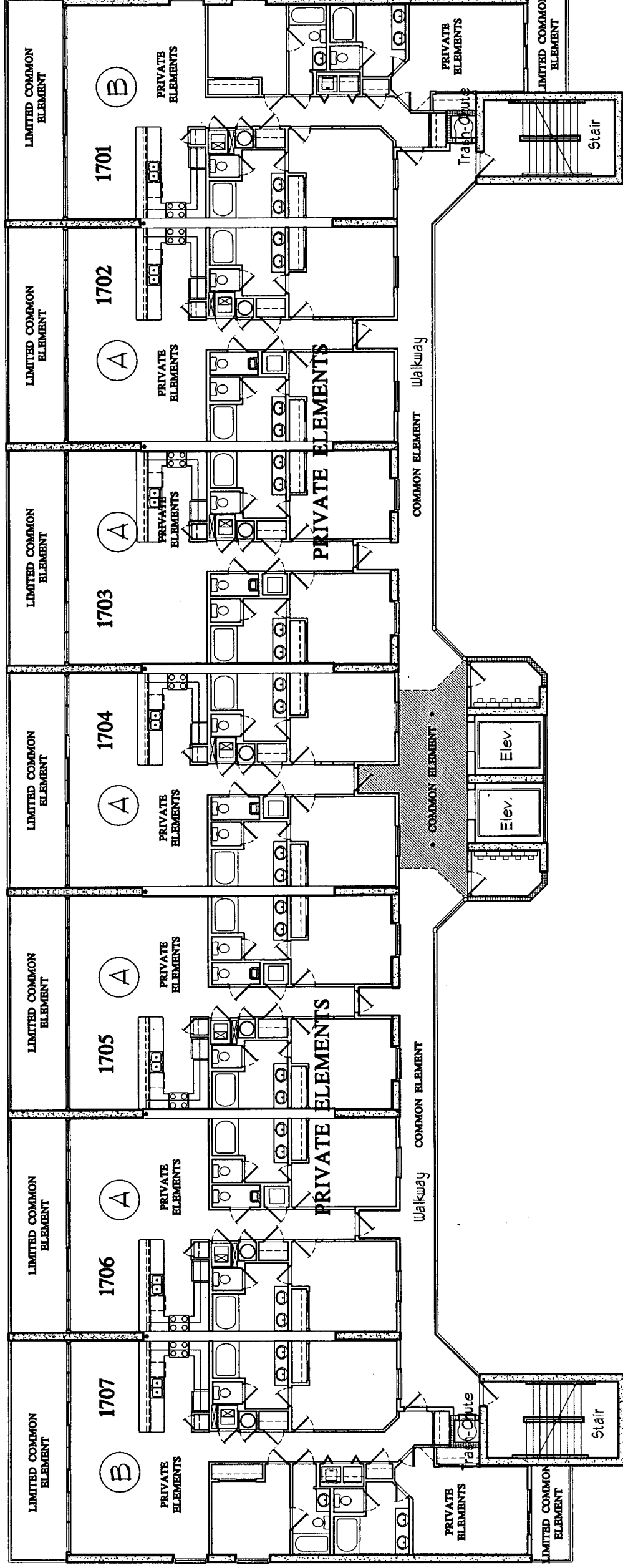

Typical Building Level 16
N.T.S.

NOTE:
ALL RESIDENTIAL UNIT BALCONIES ARE TO BE LIMITED COMMON ELEMENT
ALL RESIDENTIAL UNITS ARE TO BE PRIVATE ELEMENT
ALL WALKWAYS ARE TO BE COMMON ELEMENT
ALL OTHER AREAS TO BE COMMON ELEMENT UNLESS OTHERWISE NOTED

