



HENRY
NORRIS &
ASSOC., INC.

ARCHITECTURE &
ENVIRONMENTAL
DESIGN

30 N. PALAFOX
PENSACOLA,
FLORIDA 32502

(850) 432-6011
FAX 435-9001
henry@lnorris.com

Gulf Shores, Alabama
Ganibel Condominium

JOB NO.: 2004-28

CAD: RAB

CHECKED: HNN

DATE: 12/01/04

REVISIONS:

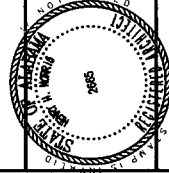

SHEET

P17

OF 26

THE UNDERSIGNED, HENRY NORRIS, A REGISTERED ARCHITECT IN THE STATE OF ALABAMA, REGISTRATION NUMBER 2658, PURSUANT TO SECTION 55-A-208, CODE OF ALABAMA, 1975, HEREBY CERTIFIES THAT TO THE BEST OF HIS KNOWLEDGE, THE DRAWINGS CONSISTING OF THESE PLANS, SPECIFICATIONS, AND CONTRACT DOCUMENTS FOR THE CONDOMINIUM PROJECTED BY AND FOR HENRY NORRIS & ASSOCIATES, INC., A PROFESSIONAL CORPORATION, ARE COMPLETE, FULLY ACCURATE, AND CORRECTLY REFLECT THE LAYOUT, LOCATIONS, UNIT NUMBERS AND DIMENSIONS OF ALL COMMON ELEMENTS AND PRIVATE ELEMENTS COMPRISING EACH UNIT OF SAID CONDOMINIUM AS BUILT.
KABARK REGISTRATION NUMBER 2885
DATE: 12/20/06

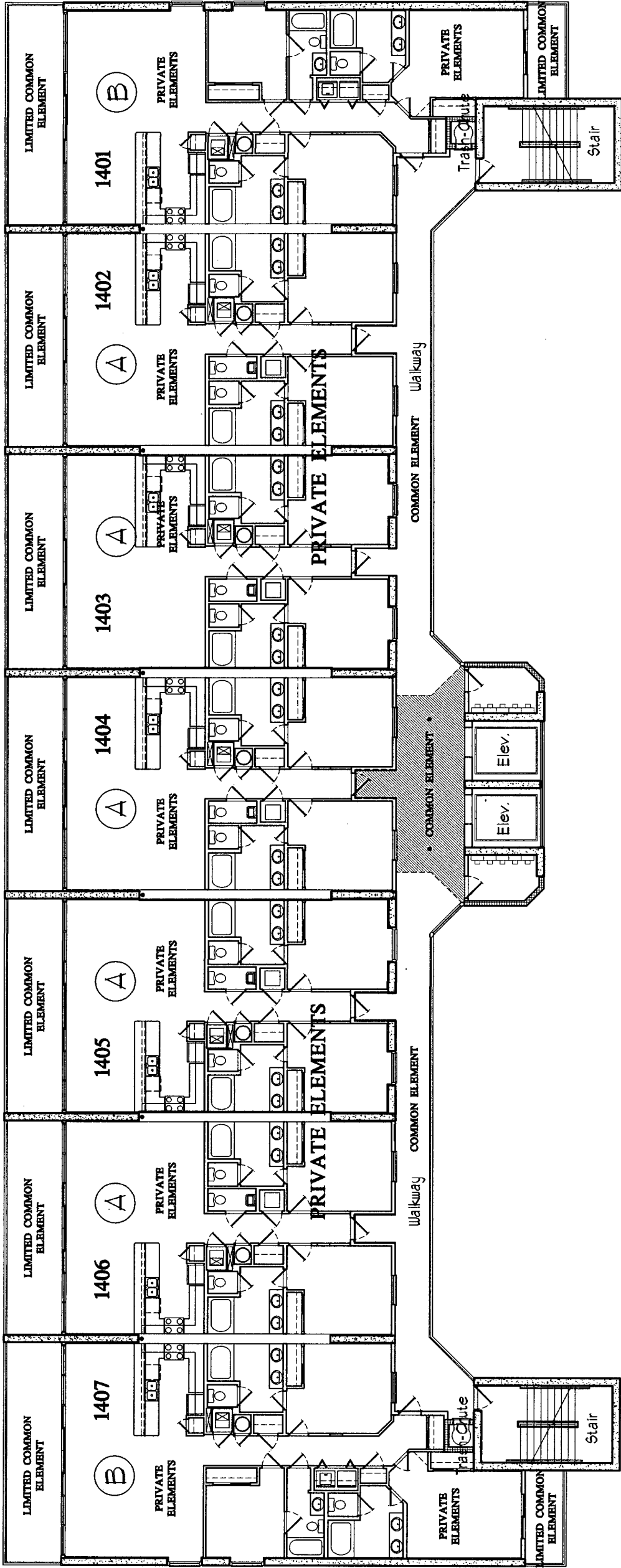

Typical Building Level 13
N.T.S.

NOTE:
ALL RESIDENTIAL UNIT BALCONIES ARE TO BE LIMITED COMMON ELEMENT
ALL RESIDENTIAL UNITS ARE TO BE PRIVATE ELEMENT
ALL WALKWAYS ARE TO BE COMMON ELEMENT
ALL OTHER AREAS TO BE COMMON ELEMENT UNLESS OTHERWISE NOTED

APT Book 25 page 50