

NOTE:
 ALL COVERED PARKING SPACES ARE TO BE COMMON ELEMENT
 ALL OTHER AREAS TO BE COMMON ELEMENT UNLESS OTHERWISE NOTED

Pool Above

PARKING SPACES
 LIMITED COMMON ELEMENT

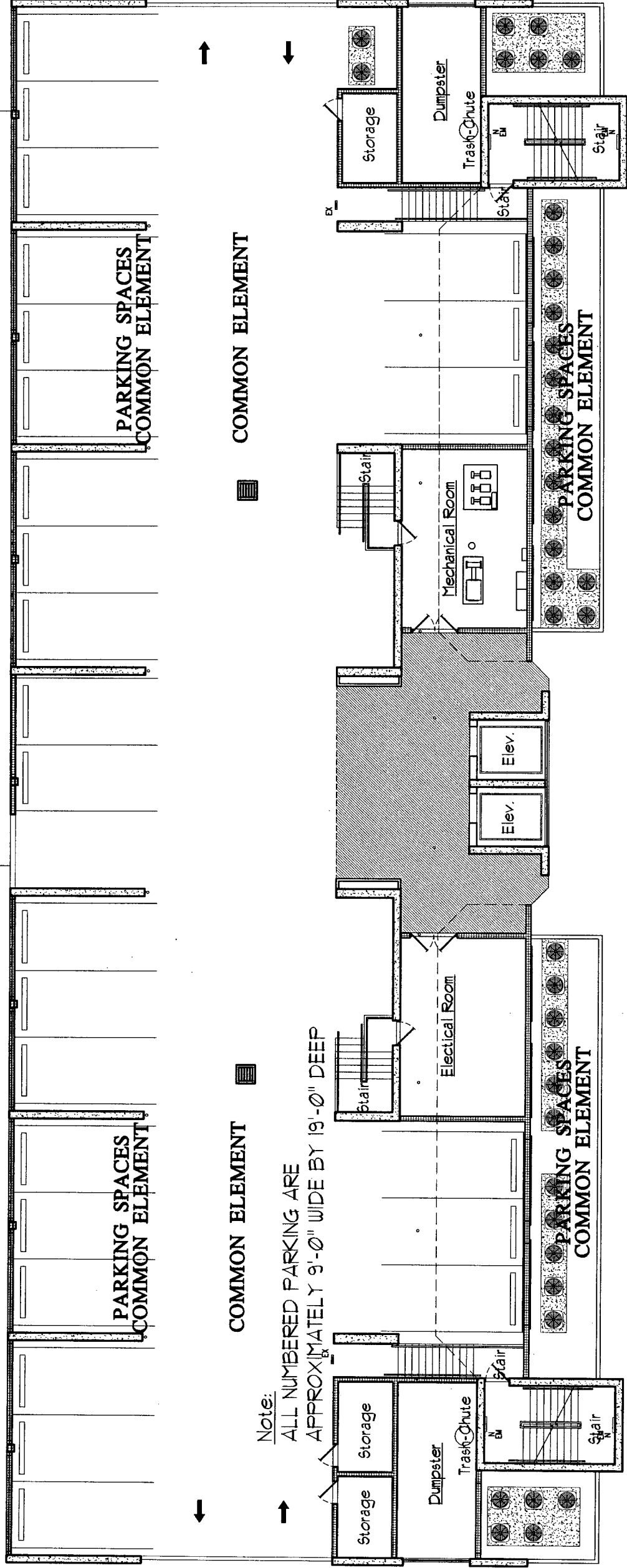

Note:
 ALL NUMBERED PARKING ARE
 APPROXIMATELY 9'-0" WIDE BY 19'-0" DEEP

Typical Building Level 01
 N.T.S.

THE UNDERSIGNED, HENRY NORRIS, A REGISTERED ARCHITECT IN THE STATE OF ALABAMA, HEREBY CERTIFIES THAT TO THE BEST OF HIS KNOWLEDGE AND BELIEF, THE DRAWINGS, SPECIFICATIONS AND CONTRACT DOCUMENTS ATTACHED TO AND MADE PART OF THE DECLARATION OF CONDOMINIUM FOR THE PROJECT OF THE COMMON ELEMENTS OF THE CONDOMINIUM, INCLUDING BUT NOT LIMITED TO THE COMMON ELEMENTS, ARE ACCURATE AND COMPLETE AND THAT HE HAS NOT BEEN ADVISED OF ANY MATERIAL OMISSIONS OR INADEQUACIES IN THE COMMON ELEMENTS. APPROXIMATE DIMENSIONS AND SPECIFIC DETAIL TO IDENTIFY THE COMMON ELEMENTS AND PRIVATE ELEMENTS COMPRISING SUCH UNITS OF THE CONDOMINIUM ARE:

Handwritten: 12/20/06
 DATE

APT BOOK 25 page 38

