

APP. BK 22 PG 157

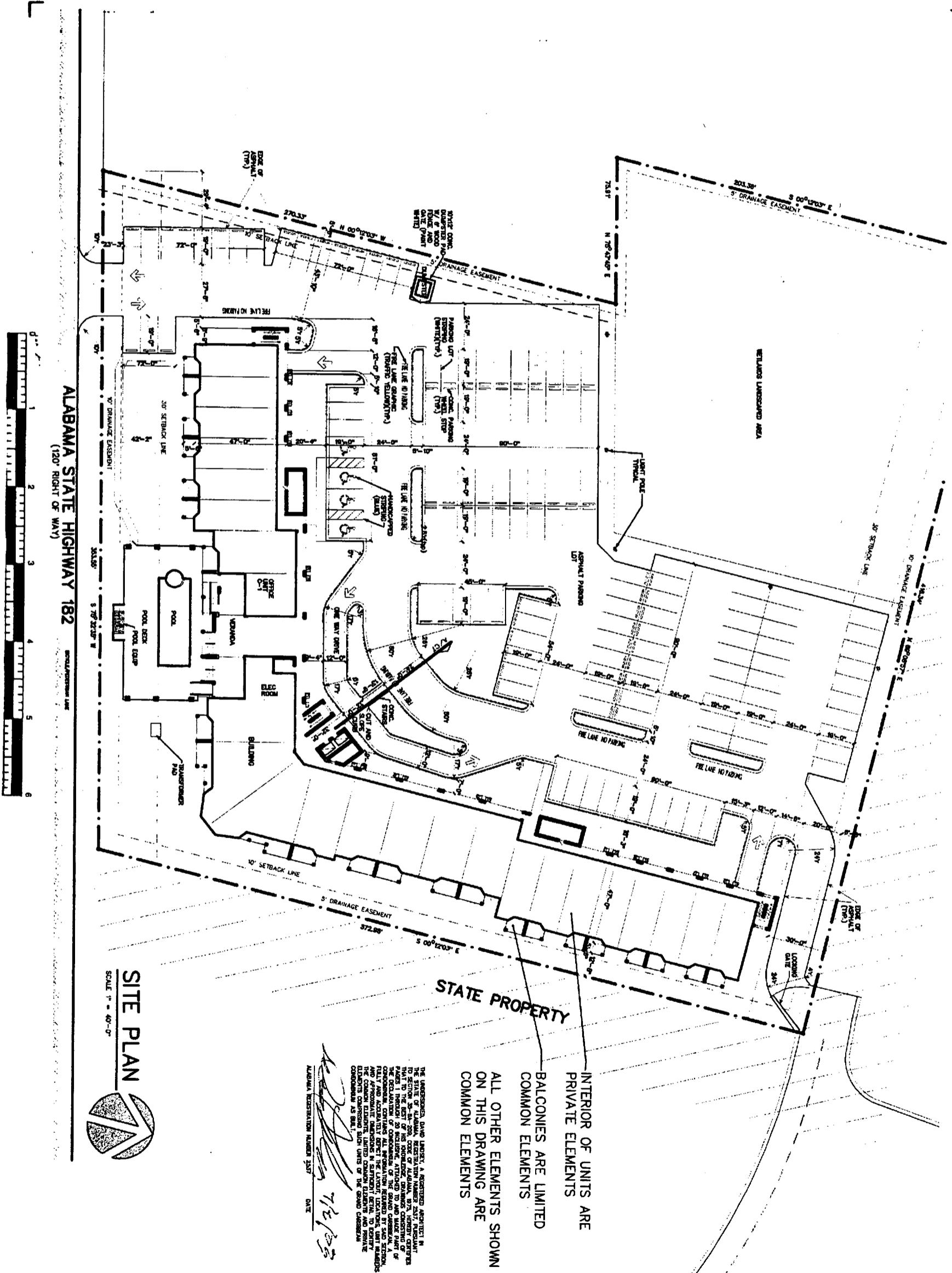

STATE PROPERTY

INTERIOR OF UNITS ARE PRIVATE ELEMENTS
 BALCONIES ARE LIMITED COMMON ELEMENTS
 ALL OTHER ELEMENTS SHOWN ON THIS DRAWING ARE COMMON ELEMENTS

THE UNDERSIGNED, DAVID LINDSEY, A REGISTERED ARCHITECT IN THE STATE OF ALABAMA, RESERVATION NUMBER 2017, HEREBY CERTIFY THAT THIS PLAN, TOGETHER WITH THE SPECIFICATIONS AND NOTES ATTACHED HERETO, IS A TRUE AND ACCURATE REPRESENTATION OF THE DESIGN AND CONSTRUCTION OF THE PROJECT DESCRIBED HEREIN, AND THAT I AM NOT PROVIDING ANY SERVICES TO THE CLIENT UNDER THIS CONTRACT THAT ARE NOT DESCRIBED IN THE CONTRACT DOCUMENTS. I AM NOT PROVIDING ANY SERVICES TO THE CLIENT UNDER THIS CONTRACT THAT ARE NOT DESCRIBED IN THE CONTRACT DOCUMENTS. I AM NOT PROVIDING ANY SERVICES TO THE CLIENT UNDER THIS CONTRACT THAT ARE NOT DESCRIBED IN THE CONTRACT DOCUMENTS.

DAVID LINDSEY
 ALABAMA REGISTRATION NUMBER 2017
 DATE 7/2/23

SITE PLAN



SCALE 1" = 40'-0"

SHEET NO. 1 OF 1

A Multi-Family Development
The Grand Caribbean
 Condominium
 Orange Beach, Alabama

DAVID LINDSEY, ARCHITECT
 DESIGN, PLANNING, INTERIORS
 (251) 454-7215
 104 RIVEROAKS DRIVE FAIRHOPE ALABAMA 36532

