

**MDS**

STATE OF ALABAMA  
COUNTY OF MOBILE  
I, **MIKELL D. SPEAKS**, a duly qualified and licensed Professional Engineer in the State of Alabama, do hereby certify that the enclosed plat is a true and correct copy of the original as shown to me by the engineer in charge of the same.

APPROVED BY ME, **MIKELL D. SPEAKS**, REGISTERED PROFESSIONAL ENGINEER, No. 12345, State of Alabama, on this **20th** day of **January**, 1998.



GULF OF MEXICO

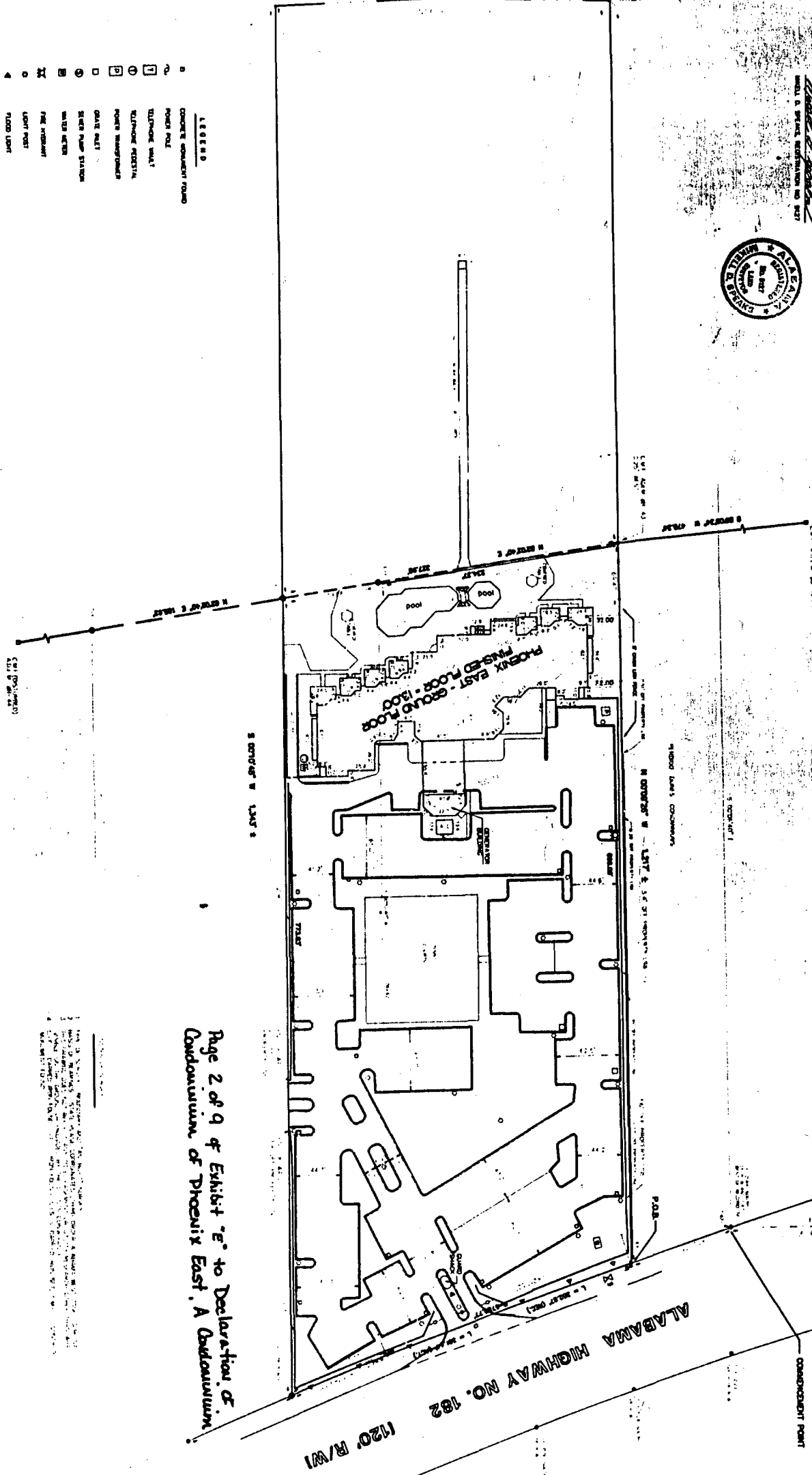

- LEGEND**
- 1 CONCRETE CONDUIT ROAD
  - 2 POWER POLE
  - 3 TELEPHONE WALL
  - 4 ULTIMATE FUTURE
  - 5 POWER TRANSDUCER
  - 6 GATE VALVE
  - 7 SEWER MAN STATION
  - 8 WATER METER
  - 9 FIVE METER
  - 10 LIGHT POLE
  - 11 FLOOD LIGHT
  - 12 WATER VALVE

SCALE 1" = 50'

FILED IN  
MOBILE COUNTY  
ALABAMA  
JAN 20 1998

Page 2 of 9 of Exhibit "e" to Declaration of Condominium of Phoenix East, A Condominium.

**MIKELL D. SPEAKS & ASSOCIATES · CONSULTING ENGINEERS, INCORPORATED**  
782 OAK CIRCLE DRIVE WEST · MOBILE, ALABAMA

PHOENIX EAST  
AS BUILT SURVEY  
ORANGE BEACH, ALABAMA

100 015 249