

Apr 06 22 19 35

NOTE:  
 ALL RESIDENTIAL UNIT BALCONIES ARE TO BE LIMITED COMMON ELEMENT.  
 ALL RESIDENTIAL UNITS ARE TO BE PRIVATE ELEMENT.  
 ALL OTHER AREAS TO BE COMMON ELEMENTS UNLESS OTHERWISE NOTED.

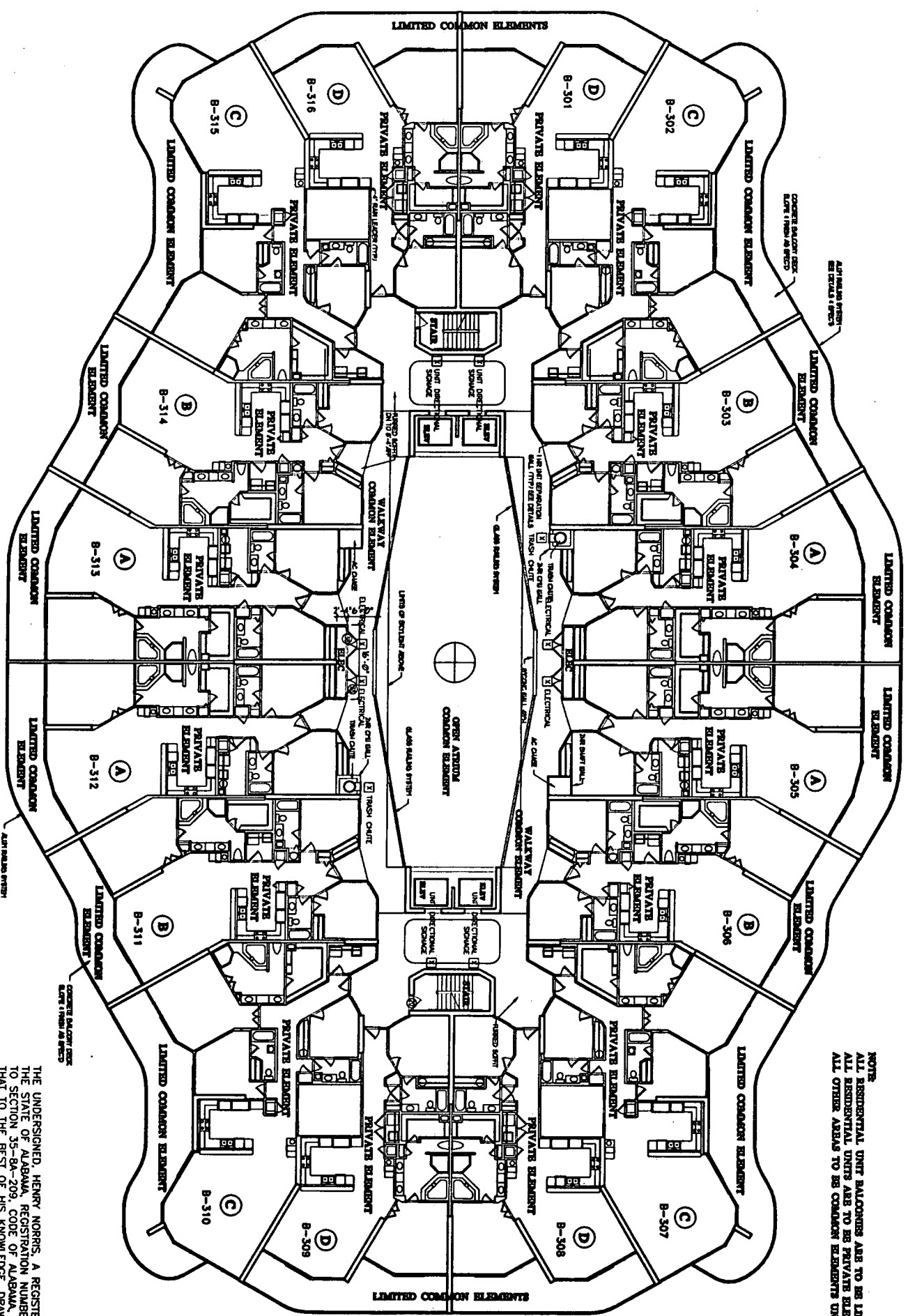

TYPICAL FLOOR PLAN LEVEL 4

THE UNDERSIGNED, HENRY NORRIS, A REGISTERED ARCHITECT IN THE STATE OF ALABAMA, REGISTRATION NUMBER 2665, PURSUANT TO SECTION 35-8A-209, CODE OF ALABAMA, 1975, HEREBY CERTIFIES THAT TO THE BEST OF HIS KNOWLEDGE, DRAWINGS CONSISTING OF PAGES 1 THROUGH 32 INCLUSIVE, ATTACHED TO AND MADE PART OF THE DECLARATION OF CONDOMINIUM OF CARIBE RESORT, A CONDOMINIUM, CONTAINS ALL INFORMATION REQUIRED BY SAID SECTION, FULLY AND ACCURATELY DEPICT THE LAYOUT, LOCATIONS, UNIT NUMBERS AND APPROXIMATE DIMENSIONS IN SUFFICIENT DETAIL TO IDENTIFY THE COMMON ELEMENTS, LIMITED COMMON ELEMENTS AND PRIVATE ELEMENTS COMPRISING SUCH UNITS OF CARIBE RESORT CONDOMINIUM, AS BUILT.

ALABAMA REGISTRATION NUMBER 2665 DATE

*Henry Norris*

Sheet 5 of 23

**CARIBE RESORT**  
 ORANGE BEACH, ALABAMA

**HN**  
 HENRY NORRIS & ASSOC., INC.  
 ARCHITECTURE & ENVIRONMENTAL DESIGN  
 20 N. PALANX  
 PENSACOLA, FLORIDA 32501  
 (850) 433-6011  
 FAX 433-5011  
 henry@hnva.com

DES. NO.	PROJECT
NO.	NO.
CHECKED	DATE
DATE	4/4/02
REVISIONS	

TYP FLOOR PLAN  
 SHEET  
**5**  
 OF 23