

Appt BK 22 PG 59

THE UNDERSIGNED, HENRY MORRIS, A REGISTERED ARCHITECT IN THE STATE OF ALABAMA, REGISTRATION NUMBER 2885, HEREBY CERTIFIES TO SECTION 15-6A-208, SCHEMATIC NUMBER 2885, HEREBY CERTIFIES THAT TO THE BEST OF HIS KNOWLEDGE, DRAWINGS CONSISTING OF PAGES 1 THROUGH 32 INCLUSIVE, ATTACHED TO AND MADE PART OF THE DECLARATION OF CONDOMINIUM OF CARIBE RESORT, A CONDOMINIUM, CONTAINS ALL INFORMATION REQUIRED BY SAID SECTION, FULLY AND ACCURATELY DEPICT THE LAYOUT, LOCATIONS, UNIT NUMBERS AND APPROXIMATE DIMENSIONS IN SUFFICIENT DETAIL TO IDENTIFY THE ELEMENTS, LIMITED COMMON ELEMENTS AND PRIVATE ELEMENTS COMPRISING SUCH UNITS OF CARIBE RESORT CONDOMINIUM, AS BUILT.

H.M.
 ALABAMA REGISTRATION NUMBER 2885
 DATE 4/1/82

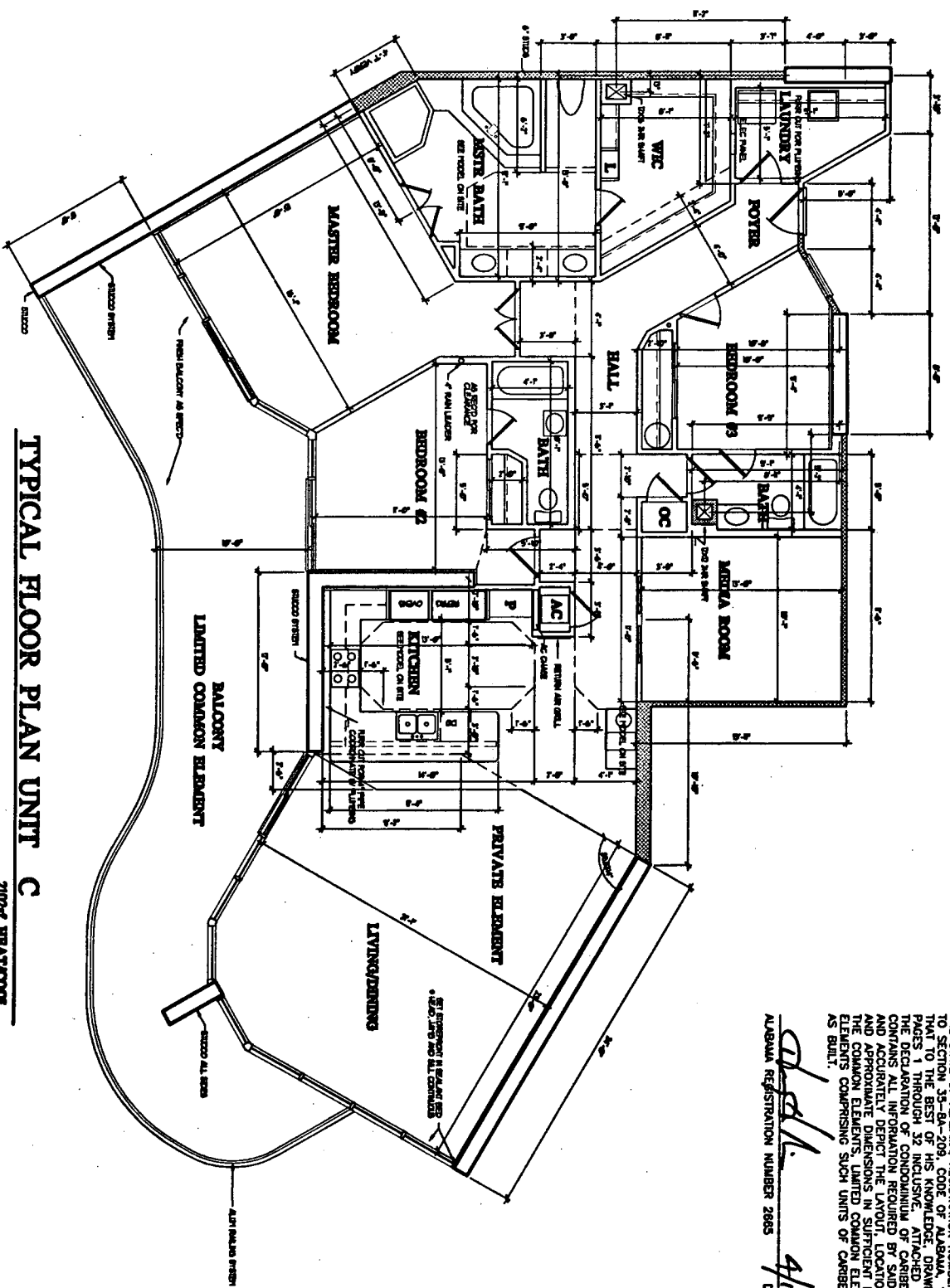

TYPICAL FLOOR PLAN UNIT C

2100[±] MASTER ROOM
 572[±] BALCONY
 2692[±] TOTAL

NOTE
 ALL RESIDENTIAL UNIT BALCONIES ARE TO BE LIMITED COMMON ELEMENT.
 ALL RESIDENTIAL UNITS ARE TO BE PRIVATE ELEMENT.
 ALL OTHER AREAS TO BE COMMON ELEMENTS UNLESS OTHERWISE NOTED.

1 Attachment SAITS Page 20 of 23

© HENRY MORRIS & ASSOCIATES, INC.



	20 N. PALMWAY TALLAHASSEE, FLORIDA 32304 (904) 487-0001 FAX (904) 487-0002 hmo@hmo.com	CARIBE RESORT ORANGE BEACH, ALABAMA	JOB NO. 0908007 DATE: 4.0.82 DESIGNED BY: HMM CHECKED BY: HMM DATE: 4.0.82 REVISIONS:	SHEET 29 OF 32
	ARCHITECTURE & ENVIRONMENTAL DESIGN HENRY MORRIS & ASSOC., INC.	UNIT C		